

FOR TRENCH SECTIONS SEE DETAIL 16  
FOR STEEL SUPPORTS SEE DETAIL 18.  
FOR TRENCH COVERS SEE DETAIL 17A.

### ARRANGEMENT OF TRENCH COVERS

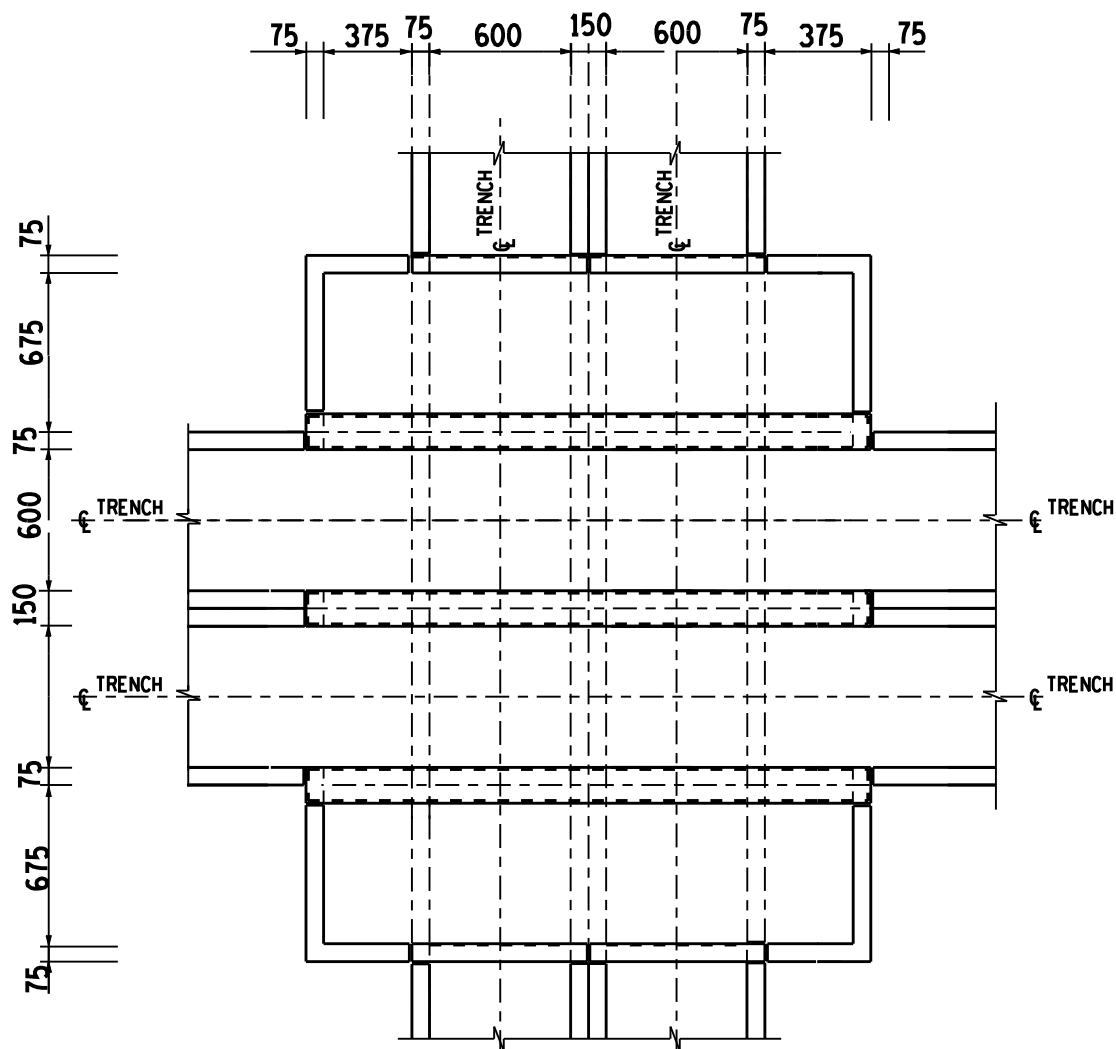

### CABLE TRENCH

DOUBLE TO DOUBLE CROSSING

TRANSMISSION  
SUBSTATION  
TECHNOLOGY  
DEPARTMENT



ESKOM

DRAWN  
GETEKEN

DJCS

27.01  
2000

CHKD  
NAGES

DBN

27.01  
2000

AUTH  
MAS

REV

0

DATE  
DATUM

H V YARD CIVIL WORK  
STANDARD DETAILS

0.54/390

SHEET 26a

DRG.TEK  
REGISTR

A4L